

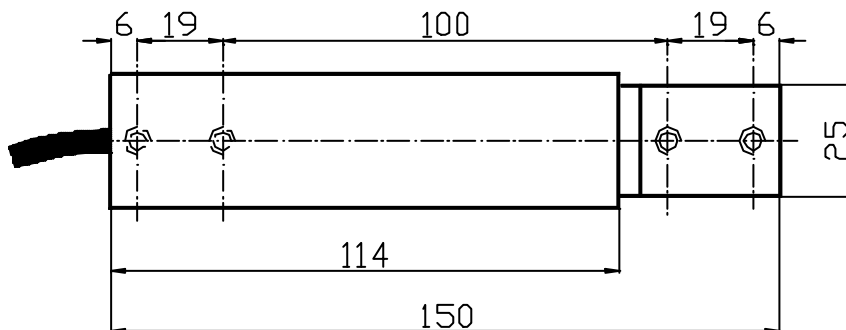

| Capacity [Kg] | OIML |
|---------------|------|
| 5 | Yes |
| 10 | Yes |
| 20 | Yes |
| 50 | Yes |
| 75 | Yes |
| 100 | Yes |

| TECHNICAL CHARACTERISTICS | |
|------------------------------------|-----------------------------|
| Max plate dimension | 400 x 400 mm |
| Rated output | 2 mV/V |
| Rated output tolerance | $\leq \pm 10\%$ |
| Maximum excitation | 15 Vcc/15 Vdc |
| Zero balance | $\leq \pm 1\%$ f.s. |
| Input resistance | 400 ± 25 ohm |
| Output resistance | 350 ± 2 ohm |
| Insulation resistance | ≥ 5000 Mohm |
| Combined error | $\leq \pm 0,025\%$ f.s. |
| Hysteresis | $\leq \pm 0,007\%$ f.s. |
| Creep 30' | $\leq \pm 0,0245\%$ f.s. |
| Temperature effect on zero balance | $\leq \pm 0,0018\%$ f.s./°C |
| Temperature effect on rated output | $\leq \pm 0,002\%$ f.s./°C |
| Compensated temperature range | -10 + +40 °C |
| Operating temperature range | -25 + +70 °C |
| Max safe load | 150% f.s. |
| Breaking load | > 300% f.s. |
| Protection class | IP65 |
| Material | Alluminium |
| Standard cable length | 5 m |
| OIML R60 C3 version | On request |

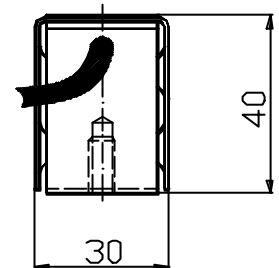
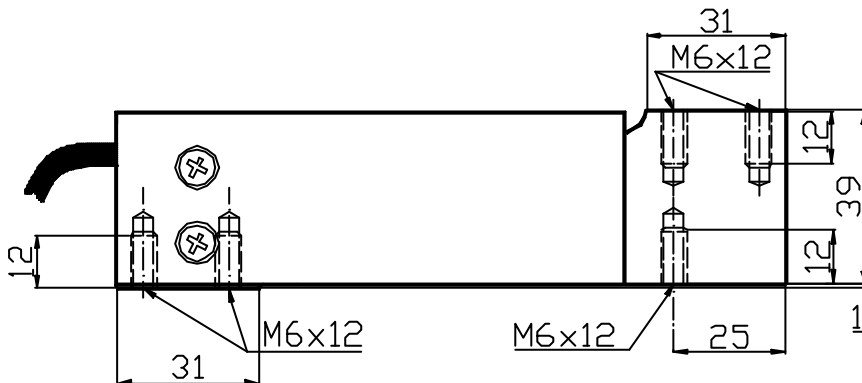

| Wiring | |
|--------|--------------|
| Red | + Excitation |
| Blue | - Excitation |
| Yellow | + Signal |
| Green | - Signal |
| White | + Reference |
| Black | - Reference |