

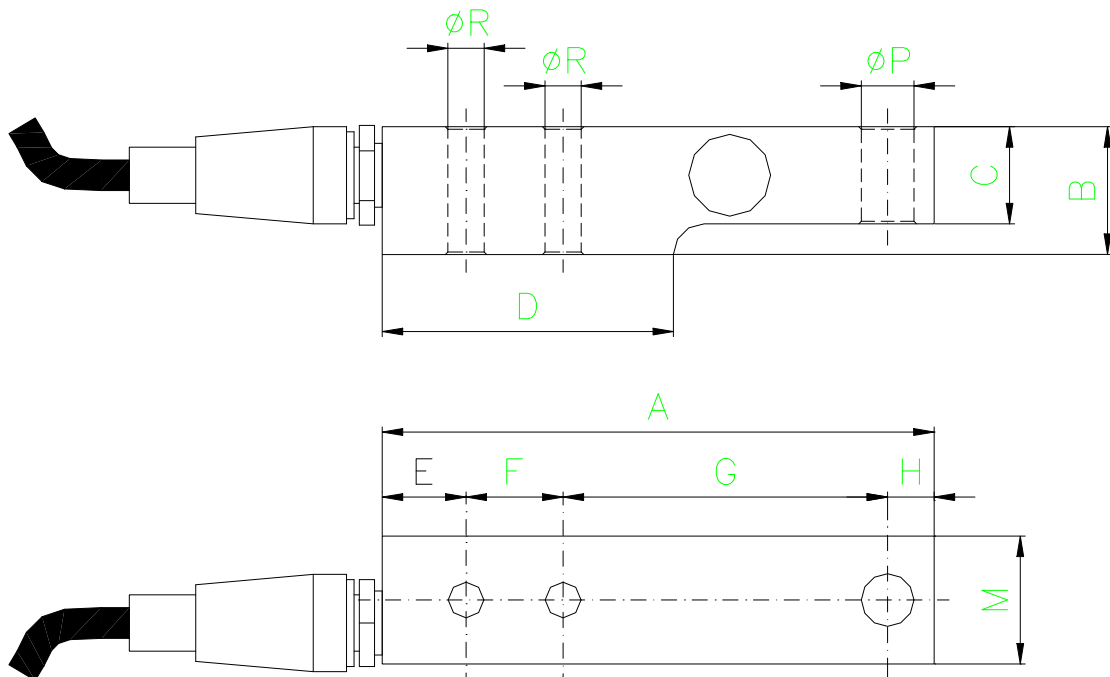

Capacity [Kg]	OIML
500	No
1000	No
1760	No
2500	No
5000	No

TECHNICAL CHARACTERISTICS	
Rated output	2 mV/V
Rated output tolerance	$\leq \pm 0,1\%$
Max excitation	15 Vcc
Zero balance	$\leq \pm 1\%$ f.s.
Input resistance	$400 \pm 20$ ohm
Output resistance	$350 \pm 2$ ohm
Insulation resistance	$\geq 2000$ Mohm
Combined error	$\leq \pm 0,025\%$ f.s.
Hysteresis	$\leq \pm 0,01\%$ f.s.
Creep 30'	$\leq \pm 0,023\%$ f.s.
Temperature effect on zero balance	$\leq \pm 0,003\%$ f.s./°C
Temperature effect on rated output	$\leq \pm 0,001\%$ f.s./°C
Compensated temperature range	-10 ÷ +40 °C
Operating temperature range	-30 ÷ +70 °C
Max safe load	150% f.s.
Breaking load	> 300% f.s.
Protection class	IP65
Material	Aluminium
Standard cable length	5 m



Capacity [Kg]	Dimensions [mm]										
	A	B	C	D	E	F	G	H	M	øP	øR
100-200-300	108	25	19	57	16,4	19	63,5	9,1	25	10,3	7,1
350-500	137	38	26,4	86	19,5	25,4	82,6	9,5	28	10,3	10,3

Wiring	
Red	+ Excitation
Blue	- Excitation
Yellow	+ Signal
Green	- Signal
White	+ Reference
Black	- Reference